



SPARE PART LIST

Spare Part ItemCode	Item name.	PictureId
6260.00002.05	ADJUSTABLE LEG M6	16
6260.00058.96	FLUE COVER CAST IRON WITH CERAMIC ENAMEL COATED FOR ALL 700&900	2
9099.00A60.00	GAS VALVE MAX-MIN ADJUSTMENT PILOT OUTPUT WITH THERMOCOUPLE SAFE 21S	20
6260.00015.46	THERMOPLASTIC KNOB MAIN BODY WITH 8 mm INSERT	21
6260.00015.40	THERMOPLASTIC KNOB SCALE MAX.-MIN FLAME-LIGHTING	22
2KLP.460.626700006.05	MAIN BURNER NOZZLE M8x0,75 ANY GAS TYPE	28
6267.00020.51	PILOT ASSEMBLY SHORT	3
6267.00002.046	BURNER ASSEMBLY 10 Kw FOR 900 SERIES GAS COOKERS	30
2179.09028.01	LABEL FOR FRONT PANEL "ÖZT RYAK LER"	35
6267.00024.00	THERMOCOUPLE 9/1 600 mm LENGTH	4
6260.00058.43	PAN SUPPORT CAST IRON W CERAMIC ENAMEL COATED FOR 900 SERIES COOKERS	5
2865.N20.08000290.G.10	FRONT PANEL FOR 80'S GAS COOKER	6



DIKKAT: BU DÖKÜMANIN COĞALTILMASI, İNTERNET ORTAMINDA DOLAŞTIRILMASI VE BU ÇİZİMLER DOĞRULUĞUNDA ÜRETİMİN YAPILMASI ÖZTİRYAKLER FİRMASININ ONAYI İLE OLABİLİR. TÜM HAKLARIMIZ SAKLIDIR.

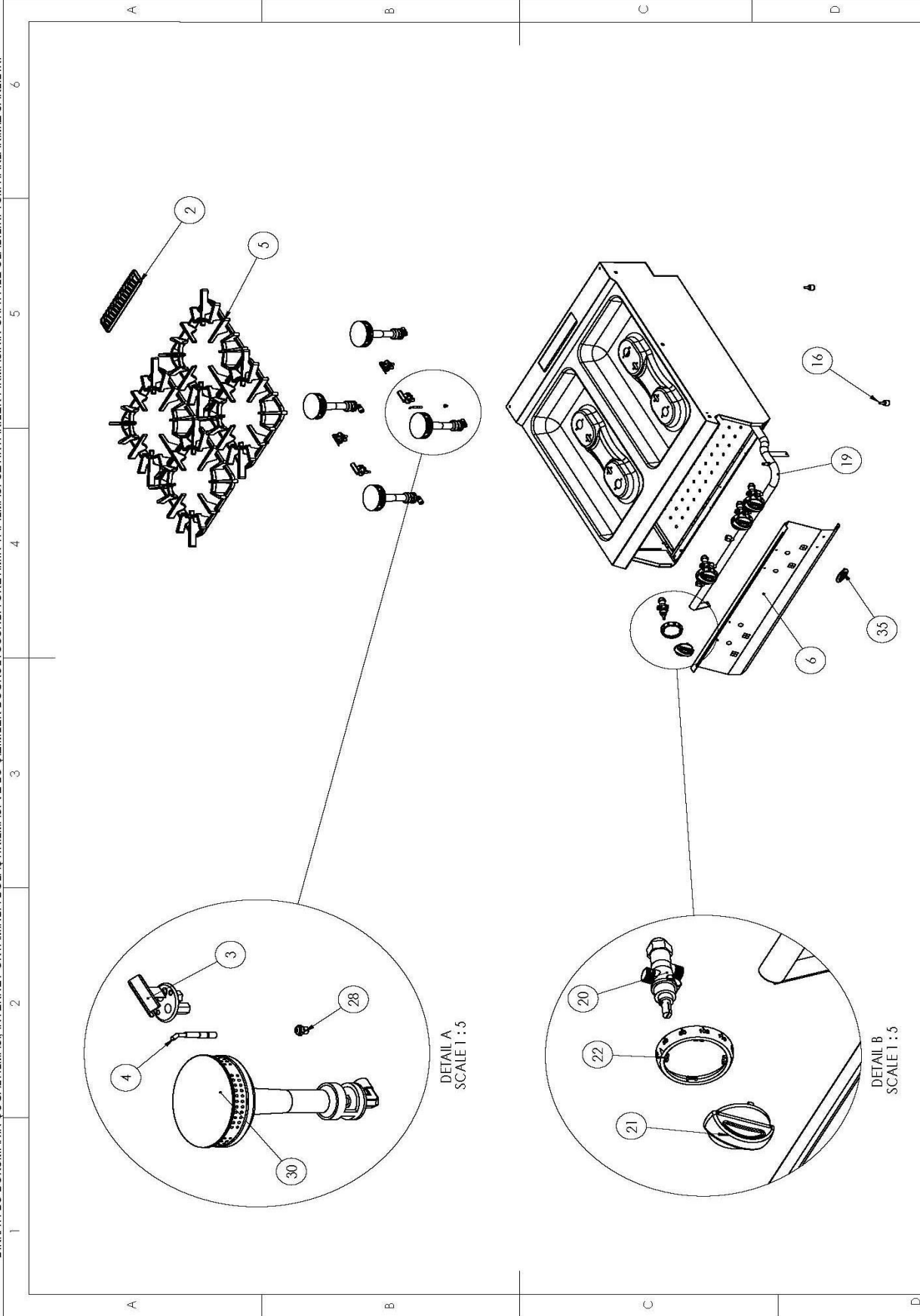

DETAIL A
SCALE 1 : 5

DETAIL B
SCALE 1 : 5

RİSD	BİM	İMCA	TARİHİ	MATERİYAL	TOLERANS
ÇİZEN	E.BAŞTUĞ		22.12.2012		DIN 71 68
KONTROL	M.HACI		22.12.2012		ORTA
ONAY	M.HACI		22.12.2012		
AGIRLIK(GR.)	41852,40	KALINLIK	REVİZYON	1	ÖLÇEK
TÜM ÖLÇÜLER mm ÇİNSİNDİR					1:50
					T. RESİM NO
					OSOG 8090 P patlamış

öztiryakler

PARÇA ADI
4 lü gazlı ocak

ARGE
KONTROLLÜ KOPYA

V13.01